

RoHS GP HF

REV.	ECR/N NO.	DESCRIPTION	DRAWN	DATE
A		NEW	CHENLIANHUI	2020/06/20
B	ER2103067	减少外壳后盖高度, 防止短路 (8%)	WUXIAOTAO	2021/03/31

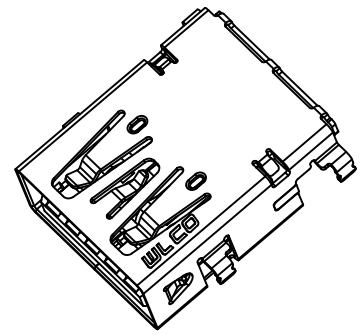
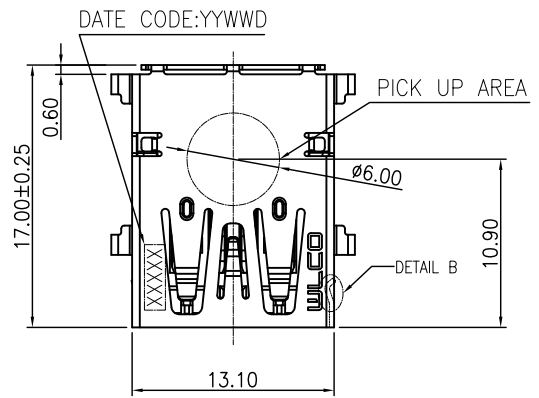

NOTE:

- MATERIAL:
  - 1-1. HOUSING: PA9T+30%G.,F; COLOR: BLACK;
  - 1-2. CONTACTS: COPPER ALLOY,T=0.20mm;
  - 1-3. SHELL: STAINLESS STEEL,T=0.30mm
- PLATING SPECIFICATION:
  - 2-1. CONTACTS:
    - NI 50u" MIN. PLATED ON OVERALL. GOLD FIASH PLATED ON THE FUNCTIONAL ARER OF CONTACT.
    - MATTE Sn 80u" MIN. PLATED ON SOLDER AREA.
  - 2-2. SHELL:
    - NI 50u" MIN. PLATED ON OVERALL.
- SPECIFICATION:
  - 3-1. ELECTRICAL:
    - CONTACT CURRENT RATING: 1.8A FOR PIN1 & PIN4
    - 0.25A FOR OTHERS.
    - INSULATION RESISTANCE: 100MΩ MIN.
    - CONTACT RESISTANCE: 30 mΩ MAX.
    - DIELECTRIC WITHSTANDING VOLTAGE: AC 100V FOR 1MINUTE
  - 3-2. MECHANICAL:
    - INSULATION FORCE: 3.57Kgf MAX.
    - REMOVAL FORCE: 1.02Kgf MIN.,0.80Kgf MIN. AFTER DURABILITY
    - DURABILITY: 5000 CYCLES
- HF COMPLIANT.

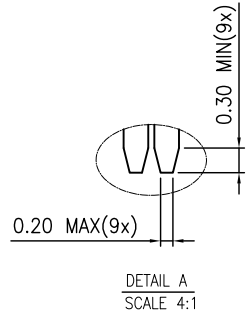
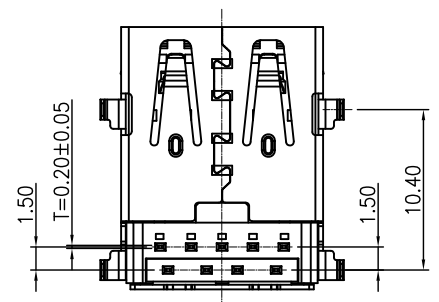
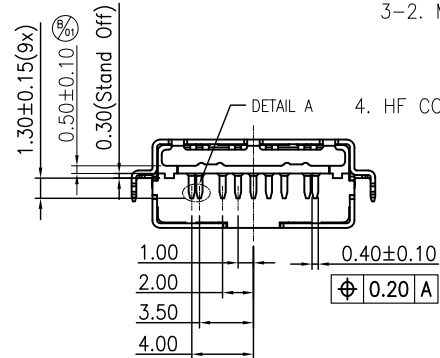
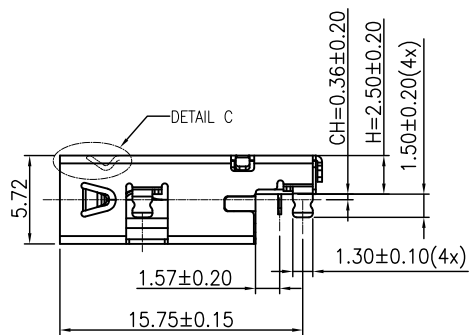
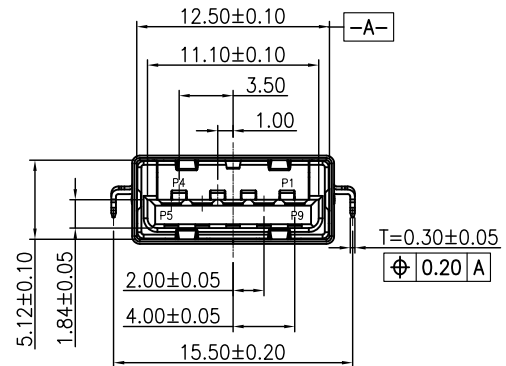

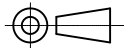
TOLERANCE	MODEL NAME:	单列5脚 2.1 A/F 后向D=0.36 P间距 无铅环保 端子半全镀锡/P 针长1.30 外壳不锈钢前盖口盖边 带刷脚 喷D.C 载带包装			DRAWN:	WUXIAOTAO
X.X ±0.35	MODEL NO:	WLUS-566B			CHECKED:	WUHUAMING
X.XX ±0.25	UNIT:	SCALE:	REVISION:	SHEET	APPROVED:	WUHUAMING
X.XXX ±0.10	mm	1:1	B	1/2	DATE:	2021/03/31
ANGLE ±1.0°	DWG NO:				FILE:	
 <b>WALCO</b> 深圳市兴万联电子有限公司 SHENZHEN XING WAN LIAN ELECTRONICS CO., LTD.				C		

RoHS GP HF

REV.	ECR/N NO.	DESCRIPTION	DRAWN	DATE
A		NEW	CHENLIANHUI	2020/06/20
B	ER2103067	减少外壳后盖高度, 防止短路 (6%)	WUXIAOTAO	2021/03/31

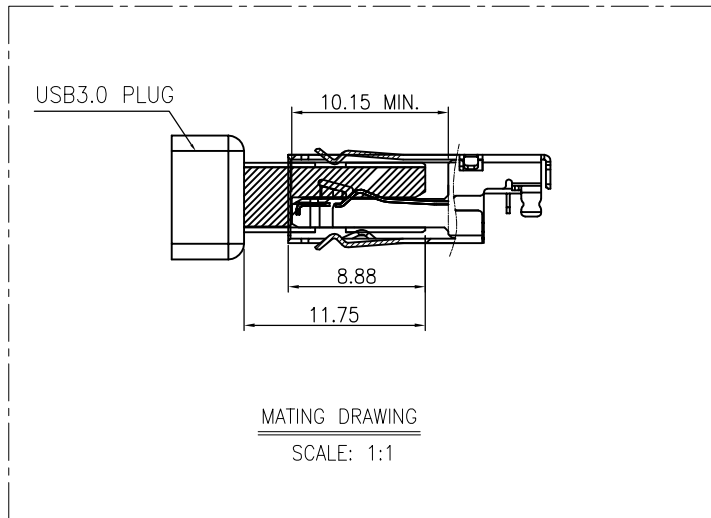
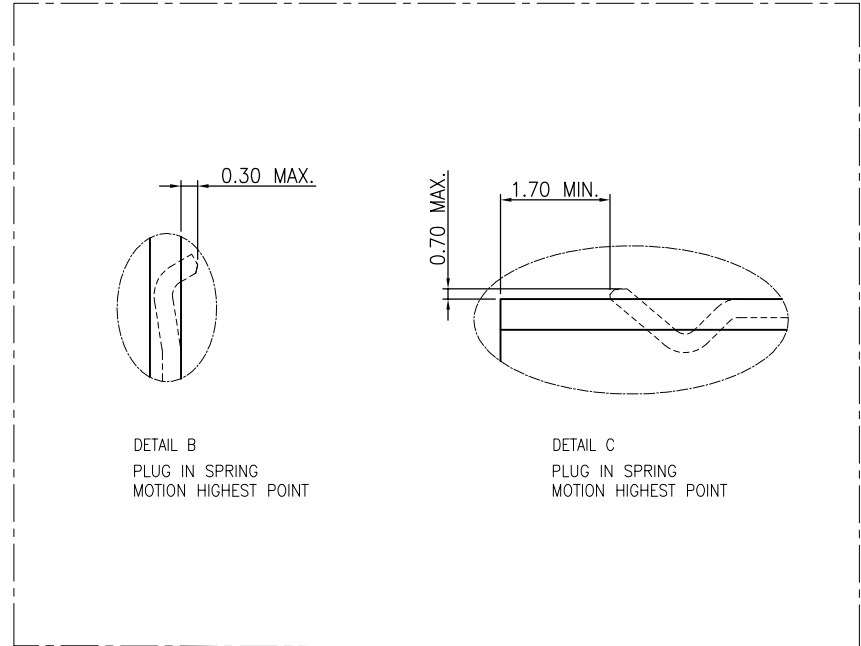
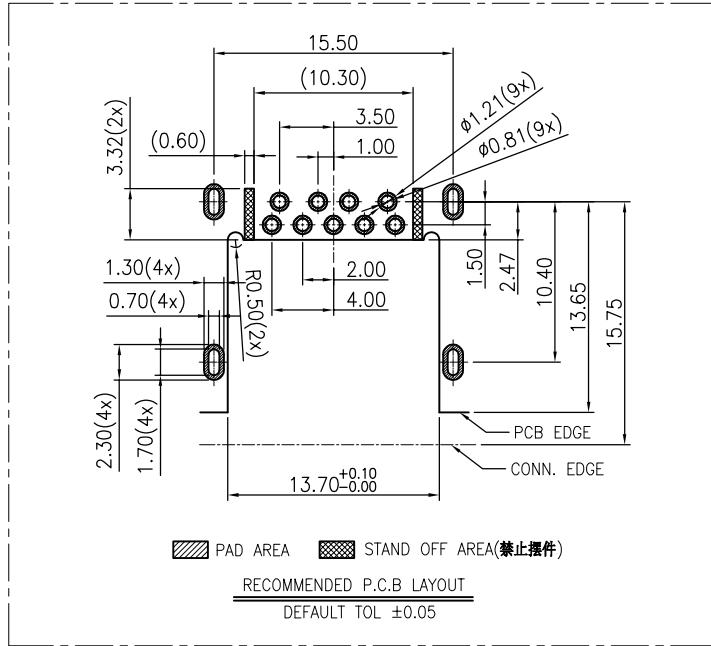

TOLERANCE	MODEL NAME: 母座USB 3.1 A/F 反向DP-0.36 F167 阻胶 无卤环保 端子半全塑模0/P 针长1.30 外壳不锈钢窗口盖出 带LED 绿/VC 胶管包胶	DRAWN:	CHENLIANHUI
X.X ±0.35	MODEL NO: WLUS-566B	CHECKED:	WUHUAMING
X.XX ±0.25	UNIT: mm	APPROVED:	YIWEIMIN
X.XXX ±0.10	SCALE: 1:1	DATE:	2021/03/31
ANGLE ±1.0°	REVISION: B	DWG NO:	
	SHEET: 2/2	FILE:	C

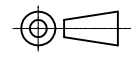

**WLCO** 深圳市兴万联电子有限公司  
SHENZHEN XING WAN LIAN ELECTRONICS CO., LTD.