

RoHS

Mark	ECN NO.	DESCRIPTION	DESIGN	Date:
A	—	New	—	—

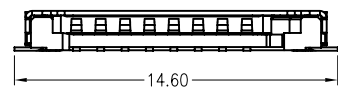

0.08

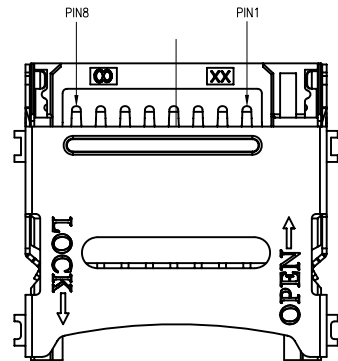
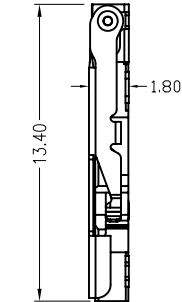

SLIDE SHELL OPEN

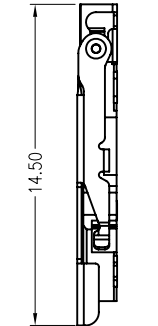

SLIDE SHELL LOCK

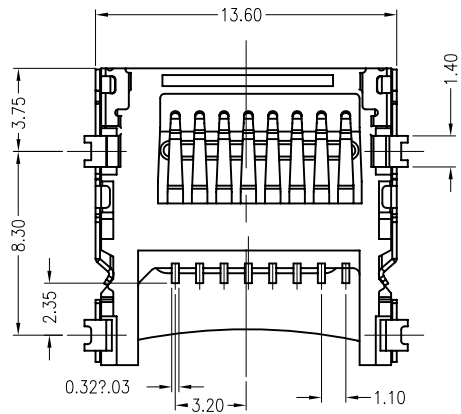

MATERIALS

- HOUSING : HI-TEMP PLASTIC UL 94V-0.
- TERMINAL: COPPER ALLOY.  
PLATING: GOLD PLATED ON CONTACT AREA,  
G/F GOLD PLATED ON SOLDER TAILS.
- SHELL : STAINLESS STEEL.  
PLATING : 50u" NICKEL UNDER, 100u" TIN OVERALL.

SPECIFICATION

- CURRENT RATING : 0.5A MAX.
- DIELECTRIC WITHSTANDING VOLTAGE :  
500V AC R. M. S. FOR 1 MINUTE.
- INSULATION RESISTANCE : 100MΩ MIN. AT 500V DC.
- CONTACT RESISTANCE : 50mΩ MAX.  
SWITCH RESISTANCE : 100mΩ MAX.
- DURABILITY : 5000 CYCLES.
- OPERATING TEMPERATURE : -30° C TO +85° C.

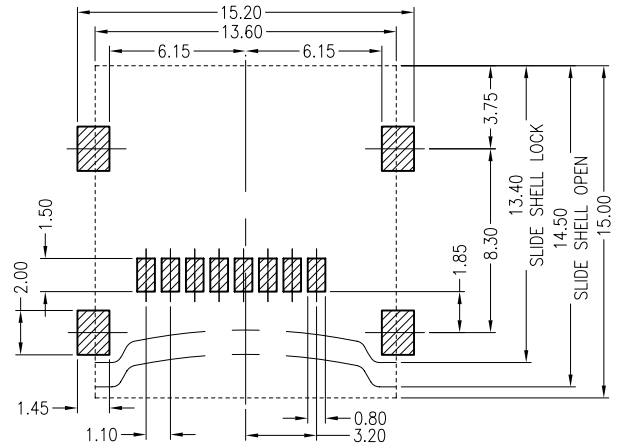
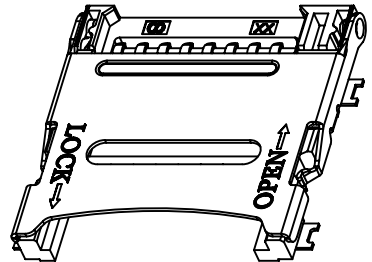

RECOMMENDED PCB LAYOUT

--- 产品外形    ▨ 焊盘

Tolerance		Model Name: T-flash卡式CARD 1.8H		Drawing: PYP	
X.X	±0.30	Model No: WLS0-014A		Checked: YSX	
X.XX	±0.25	UNIT:	SCALE:	REVISION:	SHEET
X.XXX	±0.15	mm	Full	A	1/1
Angle	±2.0°	Date: 2016.08.24		Approved: Lijian	
		<b>WLCO</b> ® 深圳市兴万联电子有限公司 SHENZHEN XINGWANLIAN TECHNOLOGY CO, LTD		DWG NO.	
				FILE: C	